

TYPICAL INSTALLATION DETAIL

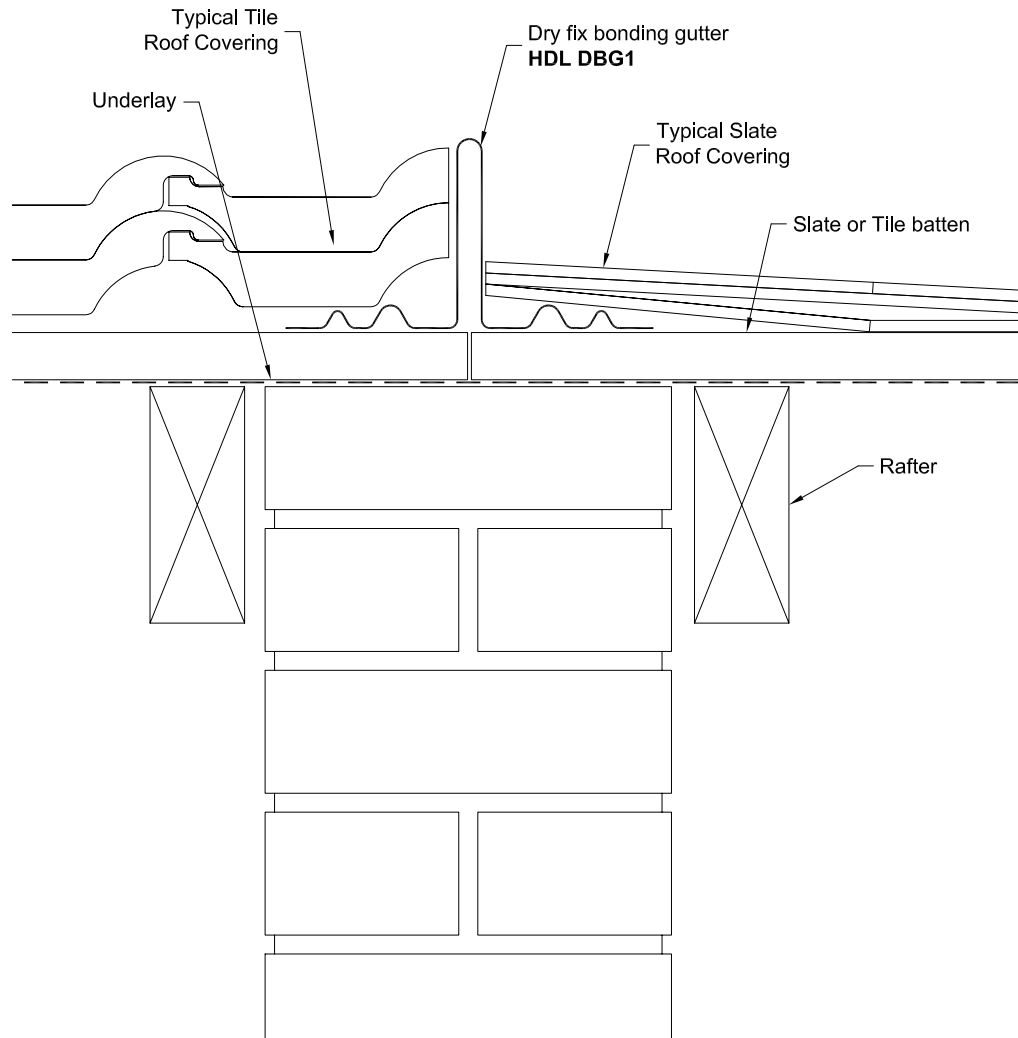

HDL DBG2

Is manufactured with a central upstand to suit profiled tiles on both sides and also typical scottish practice where there may be tiling battens on one side only.

Length: 3000mm
Central Upstand Height: 100mm
Width: 210mm

TYPICAL FIRE BREAK DETAIL

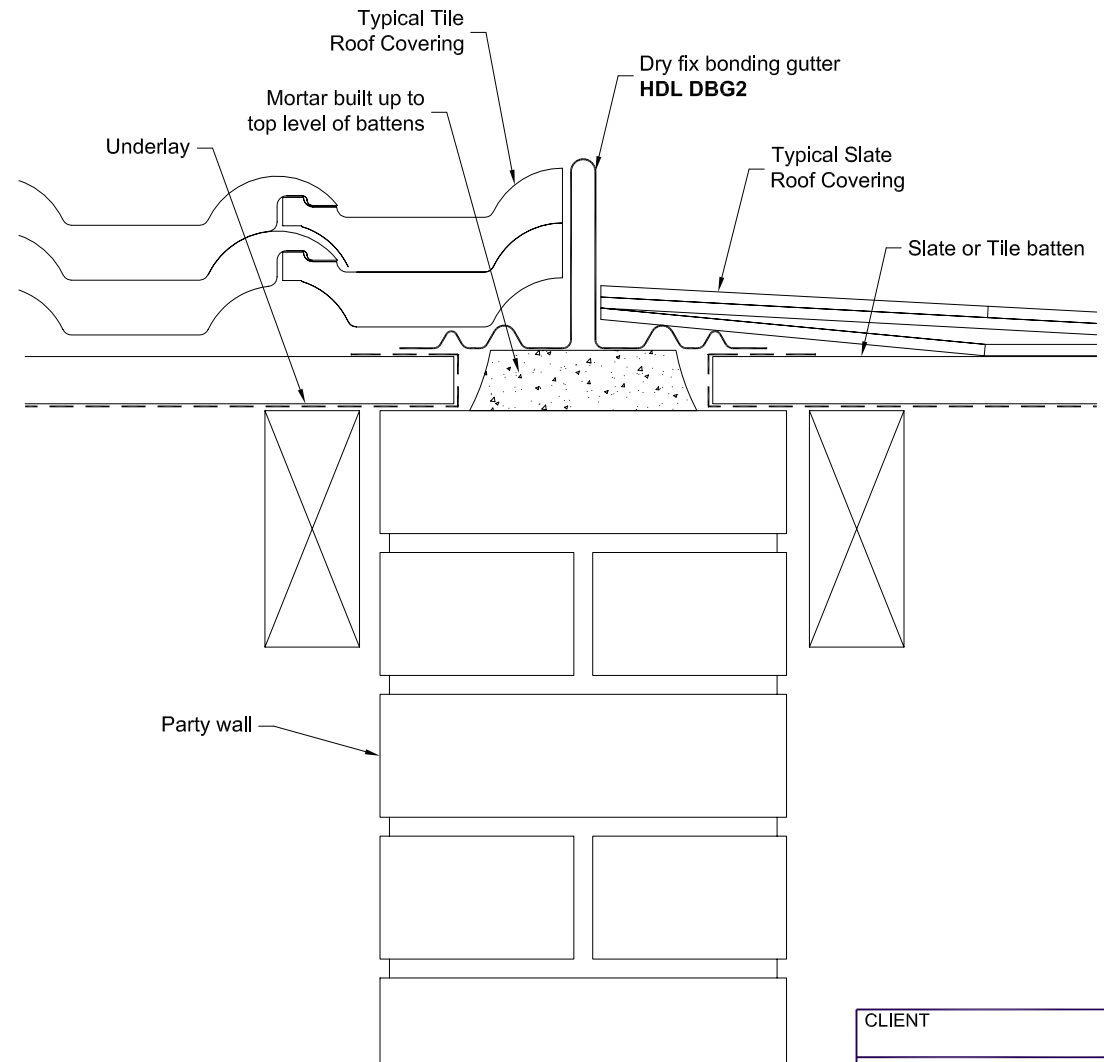

CLIENT

PROJECT

SCALE
1:4 @ A4

DATE
26.06.2013

DRAWING TITLE
Dry Fix Bonding Gutter
Typical Cross Section

DRAWING NUMBER
HDL DBG2

Hambleside Danelaw Ltd
T 01327 701900
F 01327 701909
W www.hambleside-danelaw.co.uk
A Long March, Daventry, NN11 4NR



TYPICAL SCOTTISH INSTALLATION DETAIL

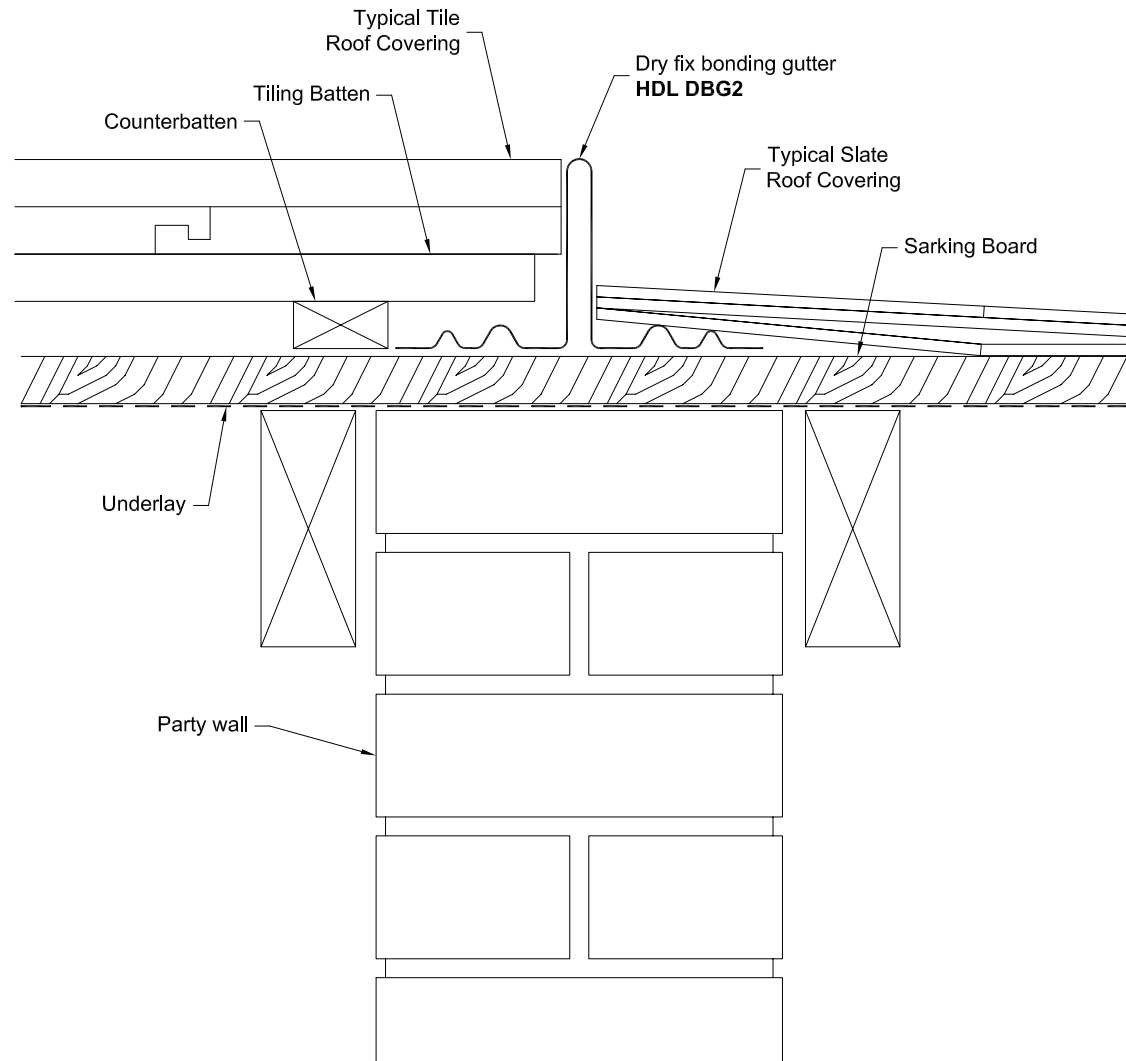

HDL DBG2

Is manufactured with a central upstand to suit profiled tiles on both sides and also typical scottish practice where there may be tiling battens on one side only.

Length: 3000mm
Central Upstand Height: 100mm
Width: 210mm

CLIENT	
PROJECT	
SCALE 1:4 @ A4	DATE 26.06.2013
DRAWING TITLE Dry Fix Bonding Gutter Typical Cross Section	
DRAWING NUMBER HDL DBG2	
Hambleside Danelaw Ltd T 01327 701900 F 01327 701909 W www.hambleside-danelaw.co.uk A Long March, Daventry, NN11 4NR	

